

## ■ Struktur Forstærknings systemer - Gre Pools

### Metal kile :

Kilen er fastgjort på betonpladen Derfor tillader dette at forberede betonfundament med en mindste tykkelse på 15 cm før samling af pool (kontroller installationsadvarsel og monteringsvideo).

Strukturforstærkninger er belagt med træ for at garantere deres integration og æstetik.

### WEDGE :

The wedge is fixed on the concrete slab Therefore, this allows preparing the concrete slab, with minimum thickness of 15 cm before assembling pool (check installation warning and assembly video). Structural reinforcements are coated with wood to guarantee their integration and aesthetics.

poolworld.dk



### NEDGRAVET STÅLBJÆLKE (IPE):

Nedgravet stålbjælke er indlejret i betonfundament med en mindste tykkelse på 17 cm. Deres installation er en del af konstruktionsmonteringsprocessen (kontroller installationsadvarsel)

### BURIED STEEL BEAM (IPE):

Buried steel beam are embedded in the concrete slab, with a minimum thickness of 17 cm Their installation is part of the structure assembly process (check installation warning)

### BARRA DI ACCIAIO (IPE):

La barra di acciaio vengono incassate nella lastra di calcestruzzo, con uno spessore minimo di 17 cm. Il loro posizionamento fa parte del processo di assemblaggio della struttura (vedere indicazioni per il montaggio).

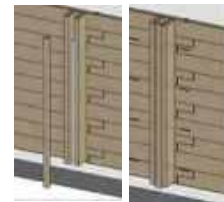
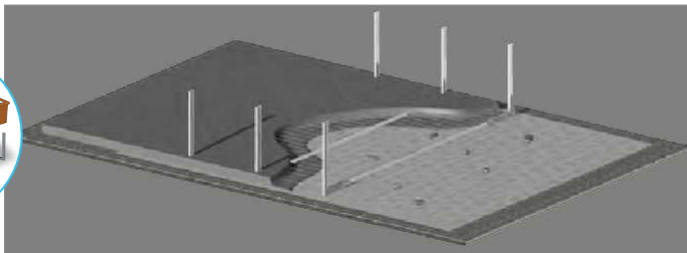
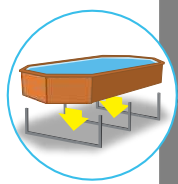

### OMEGA SYSTEM:

15x15 cm nedgravet stålbjælke. Du skal udgrave og forberede jorden til nivellering. Valgfri betonfundament.

### RENFORTS ENTERRÉS:

Poteaux en acier à enterrer de 15x15 cm. Il est nécessaire de décaper votre terrain et de mettre le terrassement de niveau. Chape béton facultative.

### OMEGA SYSTEM:

15x15 cm buried steel beam. You should excavate and prepare the land for levelling. Optional concrete slab.

### SISTEMA OMEGA:

Barra di acciaio interrata da 15x15 cm. È necessario scavare e preparare il terreno per livellarlo. Basamento di calcestruzzo opzionale.

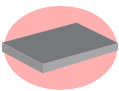
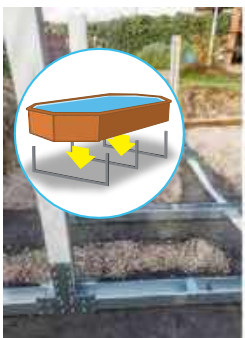

Obligatorisk  
Obligatorio  
Obligatoire  
Obbligatorio

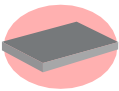

Obligatorisk  
Mandatory  
Obligatorio  
Obligatoire  
Obbligatorio



Valgfri  
Opcional  
Facultative  
Opzionale